

Module 1 : 5 hours

1.2mm Sheet: 40mm×80mm (1.2mm, 0.6mm)  
4.0mm Sq. wire: 40mm (1.2mm×2.5mm)

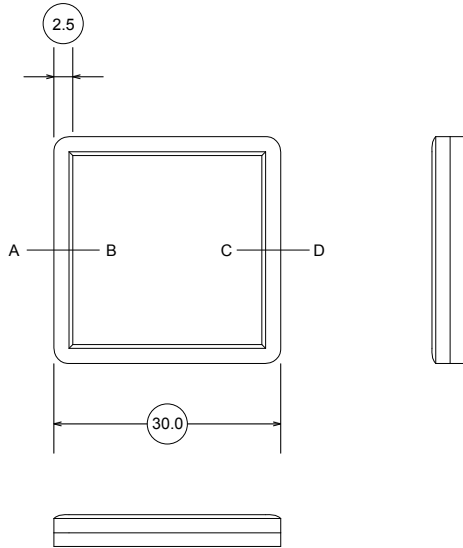

A-B Scale 2:1

C-D Scale 2:1

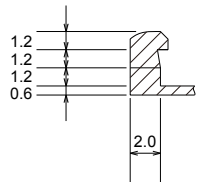

Module 2 : 5 hours

1.2mm Sheet (1.2mm×4.0mm)

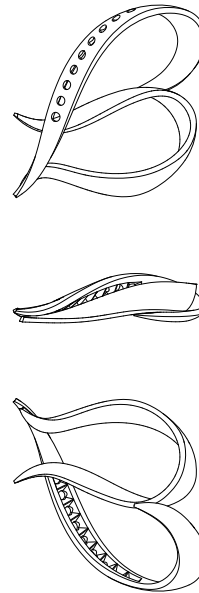

1.2mm Sheet (1.0mm)

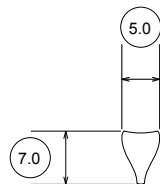

Module 3 : 5 hours

1.2mm Sheet (t0.3×φ1.5mm Round tube)

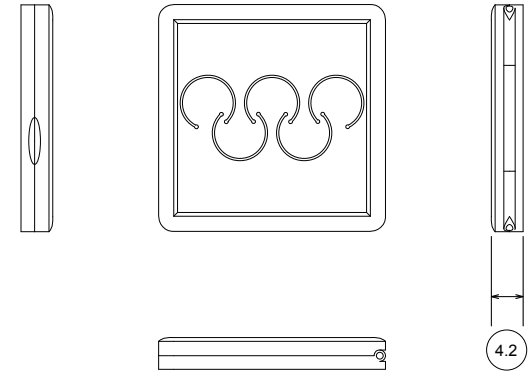

2.0mm Round wire: 100mm (0.8mm Round wire)

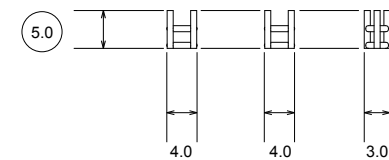

Test Project for the 43<sup>rd</sup> WorldSkills  
Competition in São Paulo, Brazil 2015.  
Copyright © 2015 WorldSkills International.  
All Rights Reserved.



Material: 18K (Y) Gold

1.2mm Sheet: 40mm×80mm  
4.0mm Sq. wire: 40mm  
2.0mm Round wire: 100mm  
Hard, medium, and easy solder  
(1gm each)

Skill: 27 - Jewellery

Scale: 1:1

Date: 3.5.15

Paper: A4

Drawn / Design by: K.Saito

Drawing No: WSC2015\_TP27\_JP\_01\_EN

Description: Locket with the design of the initial letter of Brazil  
21h modular Test Project

Rev:

Page: 2 of 1

Appd:

Sign:

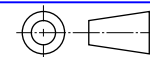

Module 4 : 6 hours

1.2mm Sheet (0.8mm×2.0mm)

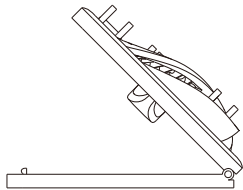
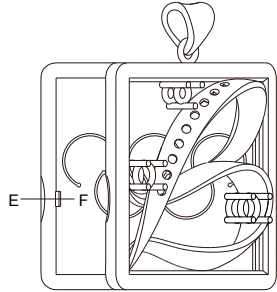

E-F Scale 2:1

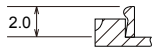

2.0mm Round wire: 100mm (0.8mm, 0.9mm Round wire)

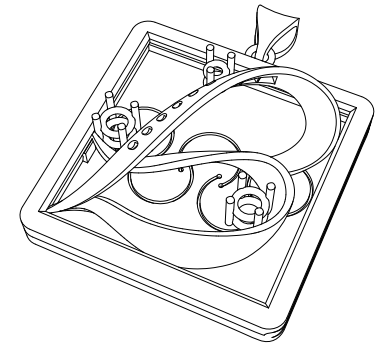
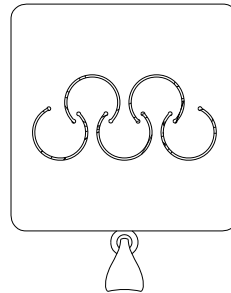
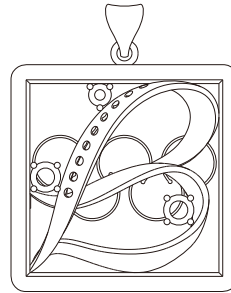

All dimensions in mm

Material: 18K (Y) Gold  
 1.2mm Sheet: 40mm×80mm  
 4.0mm Sq. wire: 40mm  
 2.0mm Round wire: 100mm  
 Hard, medium, and easy solder  
 (1gm each)

Test Project for the 43<sup>rd</sup> WorldSkills  
 Competition in São Paulo, Brazil 2015.  
 Copyright © 2015 WorldSkills International.  
 All Rights Reserved.



Skill: 27 - Jewellery			
Scale: 1:1	Date: 3.5.15		
Drawn / Design by: K.Saito		Drawing No: WSC2015_TP27_JP_02_EN	
Description: Locket with the design of the initial letter of Brazil 21h modular Test Project		Rev:	Page: 2 of 2
		Appd:	Sign: